



Planning Your Visit

School Education Programs



Learning at the Museum of Fire

Our Museum, as a world class facility on the study and history of firefighting and fire services across Australia, tells this story through significant objects, historic vehicles and interactive displays.

With fire appliances dating back to the early 1800's such as steam-powered fire engines, horse drawn carts and manual pumps to modern motorised engines, the Museum of Fire highlights how transportation technology has changed over time. Our displays showcasing uniforms, equipment, tools and tales of firefighters across time in the Museum echo the importance of our heroic firefighters who have and continue to today to support our communities.

The Museum of Fire has three different excursion programs available, all aimed at primary school students. These programs target key NSW syllabus points across PDHPE, HSIE and Science and Technology for students from Early Stage 1 to Stage 3. The Museum welcomes groups on any weekday during the school term to be able to book their excursion. We are open 7- days a week, 9:30am - 4:30pm (except Good Friday and Christmas Day).

A synopsis of our excursion programs are as follows:

Early Stage 1 - Stage 1: People in the Community

This program engages students in learning about what Firefighters do and how they do their job. Students are encouraged to take part in a role play scenario which highlights the role of all emergency services and asks students to recall what they have learned about being helpers in the community, especially Firefighters.

Stage 2: Identifying Hazards

This program engages students in learning about fire safety through the lens of personal safety, safety in the home and safety when at school. Students are led in discussion of concepts such as what is an emergency? What are fire hazards? And how can fire hazards been avoided, prevented or resolved. Students are then asked about how firefighters manage fire hazards and discuss the equipment and tools used by firefighters.

Stage 3: Bushfires

This program discusses the impact of bushfires on the environment. Students are asked to think about how bushfires differ from fire within the built-up environment and discuss how we can prevent bushfires. Students also learn how fire can be good for the environment and how Aboriginal people use fire to shape their environment.



How to make a booking

There are two ways for you to make a booking with us.

1. Using our [Online Booking Request Form](#)
2. Over the phone by calling us on (02) 4731 3000.

After we receive your booking request, we will email you written confirmation. When you receive your booking confirmation, please check that all details are correct.

Please note that an initial non-refundable deposit of \$187.50 (equivalent to our minimum booking amount of 15 students) is required 2 weeks prior to the visit to ensure that your booking is not cancelled. Invoicing is available for school groups.

Location and opening hours

The Museum of Fire is located in Penrith, Western Sydney in the heritage listed former Penrith Power Station at 1 Museum Drive, Penrith. The Museum is about an hour west of Sydney, and makes for a great day visit, or stop-off destination on your way to or from the Blue Mountains.

Getting here by car/coach

From the M4 Motorway, take the Mulgoa Road exit towards Penrith. Continue to drive down Mulgoa Road. The Museum entrance is located 1 km north of the Panthers Entertainment Centre on the right-hand side of the road after the railway underpass bridge. The entrance can easily be identified by a 1940s Dennis fire engine that is raised 4 metres off the ground.

Getting here by train

The Penrith railway station is located directly behind the Museum and is a 500 metre walk (approximately 5 minutes) from the platform to the Museum's side entry gate. Follow signs to Penrith North from the station and walk towards the multistory station carpark. The pedestrian gate is located on Combewood Avenue.

Castlereagh Road
entrance

Pedestrian access from Combewood
Avenue



School Pop-Up Shop

During your education program we can bring a small selection of products for your students to purchase in a controlled environment. All products will be \$15 and under, cash and card available. This will be factored into the timetable of your visit.



You can view all available products by visiting the Pocket Money category on www.museumoffire.net/shop or scan the QR code below

Please confirm if you would like this added onto your program before your visit.



Before your visit

Advanced bookings are essential for all educational groups. Make a booking, using our [Online Booking Request Form](#) or over the phone by calling us on (02) 4731 3000.

The minimum number required for school groups is 15 students. However, if you have fewer than 15 students and would still like to book a school education package you can pay the minimum student number of 15 students to lock in the program and one of our educators for your visit.

Prices for school excursions to the Museum are \$12.50 per student. This includes entry to the Museum, an education talk relevant to the NSW education syllabus and Australia curriculum, Emergency Services role play experience, a teacher-guided tour of the Museum and a ride on a Fire Engine. The Supervisor-to-Student Ratios is 1:10 for K-6 and 1:4 for special needs with any additional adult helpers charged at \$9.50 per person (prices effective from 1 August 2023). A non-refundable deposit of \$187.50 (15 students) must be paid in total 2 weeks prior to the date of your booking. If the deposit has not been paid a week prior to your booking, your booking will be cancelled.

Before arriving at the Museum please talk to your students about appropriate behaviour whilst visiting the Museum. We ask that students do not run while in the Museum building, remain behind display barrier ropes and do not touch objects. Please also ask your students to be considerate of other guests while in the Museum.

The school education package typically lasts about 3-hours, but it can be tailored to be as short or long as you need.

Should you require pre- and post- visit activities for the classroom, we recommend that you visit the [Fire and Rescue New South Wales website](#), the [New South Wales Rural Fire Service website](#), and our [Junior firefighters online exhibition](#)

On arrival

We suggest that you plan to arrive 30 minutes before your allocated session as this will provide sufficient time to use the facilities, have morning tea, and get settled in. For morning tea and lunch our outdoor picnic facilities are provided however, the Museum does not have a retail outlet for food and beverages so please ensure you bring your own food and water. Water bubblers are located on the premises.

Bus parking is available on site in our carpark on the right as you enter. Buses may drop students off at the entrance to the Museum before parking.

Toilets are located both inside and outside the Museum, signage will direct. Otherwise ask a staff member for assistance.

Your group should gather just outside the main entrance 10 minutes before your session start time.

A Museum Educator will then lead the group, facilitate backpack storage (if required), and remind students of appropriate behaviour while at the Museum.

On the day

To enhance your experience, your booking time will be reserved exclusively for your group. Please note however, the Museum will remain open to the general public.

A typical 3.5 hour visit with a session start time of 10:30am may look something like the below table, this is based off a smaller group size. Times will vary depending on the size of your group, students may be split up into smaller groups and rotate between the three activities (education talk, fire engine rides, and teacher-guided tour).

Time	Activity	Details
10:00am to 10:25am	Arrival	Time for students to use facilities, have morning tea, and get settled in
10:25 to 10:30am	Welcome	A Museum Educator will greet the school staff and students and inform them of expected behaviour
10:30am to 11:15am	Education talk and emergency services role play experience	Students will begin their museum excursion with an education talk, which will be followed by an interactive experience involving emergency service vehicles and uniforms. Students will also learn how emergency service personnel respond to 000 calls.
11:15 am to 11:45am	Fire engine rides	Students are invited to ride in a genuine Ford D200 Fire Truck. These trucks served from the inner city to the country during the 1960s to 1970s
11:45am to 12:30pm	Teacher guided tour	Detailed teacher guide notes are prepared for the teacher-led tour. These contain suggested prompts and questions to help encourage student interaction.
12:30 to 1:30pm	Lunch	Shared tables and chairs are available outside in our picnic grounds
1:30pm to 2:00pm	Short film	Students are then invited for a final activity to the theatre to watch a short film in relation to the excursion topic.
2:00pm	Departure	Program ends

Museum Map

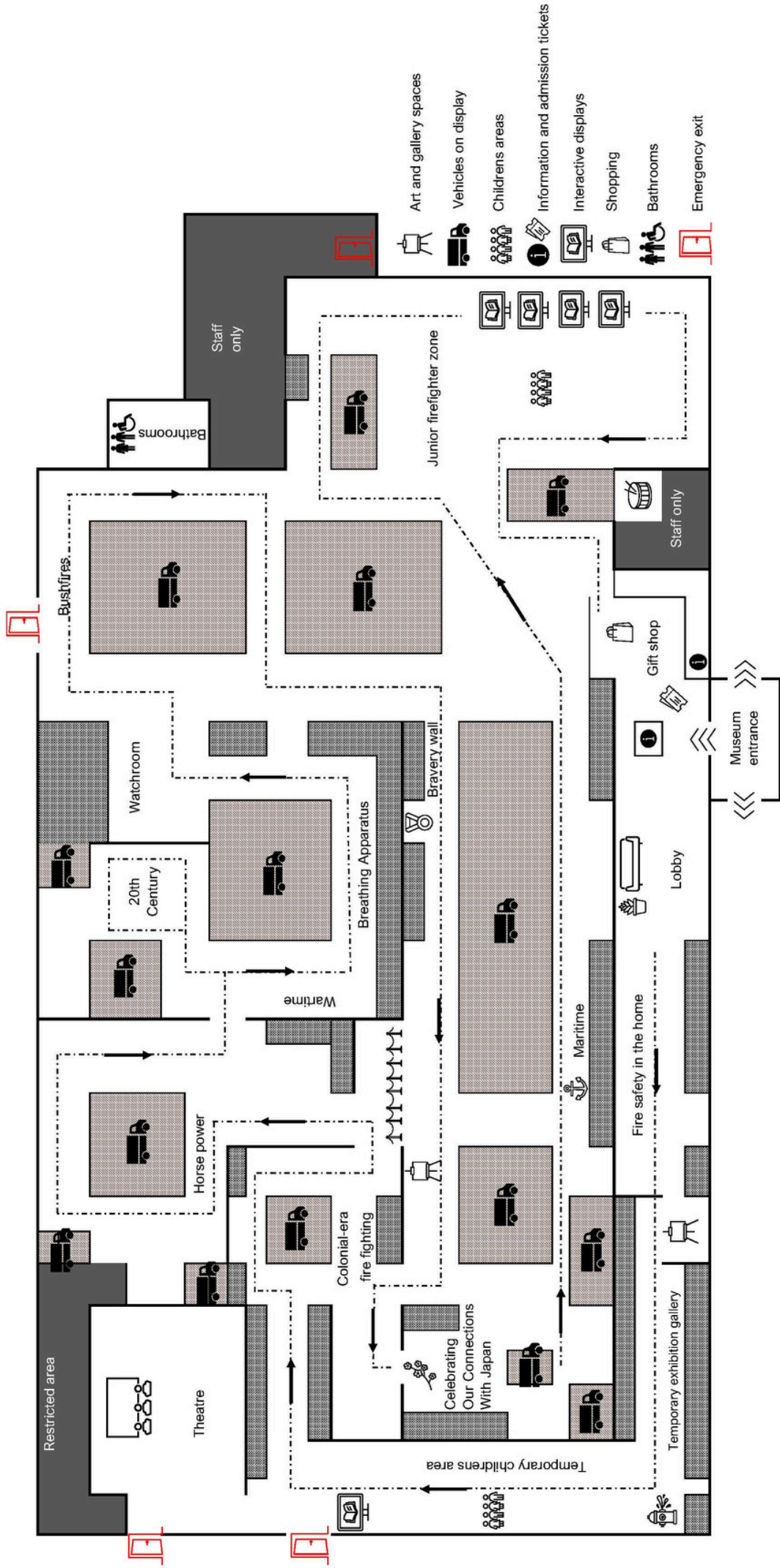



School Education Programs Overview

Early Stage 1 to Stage 3

People in the Community



Audience:
Primary School
Early Stage 1
to Stage 1



Learning Areas:
PDHPE
Geography
History



Type:
Museum Educator-led



Duration:
3.5 to 4 Hours*

Description of Program:

This program engages students in learning about what firefighters do and how they carry out their job. Students are then led in discussion with the Museum Educator about the tools and equipment that firefighters use and are shown how these have changed over time. Students are encouraged to take part in a role play scenario which highlights the role of all emergency services and asks students to recall what they have learnt about as being helpers in the community.

Students are invited to explore the Museum of Fire and its exhibitions which show the historical development of firefighting across time and how firefighters as we know them have changed. This portion is a self-guided experience where teachers are provided with a walking trail guide to pose questions to the students and provide extra information on the displays.

An optional activity is a fire engine ride in a vintage fire engine, providing the experience to the students as to what it was like for firefighters to respond under lights and sirens back in 1969.

Cost:

\$12.50 per student and teachers free of charge (per a 1:10 staffing ratio, additional adults cost \$9.50).

Deposit:

A non-refundable deposit of \$187.50 (15 students) must be paid in total 2 weeks prior to visit.

*Duration of program is dependent on size of the group and needs of the group, the Museum can tailor its programs to be shorter or longer where required.

Curriculum Links (NSW Syllabus for Australian Curriculum):

PDHPE

- Identifies people and demonstrates protective strategies that help keep themselves healthy, resilient, and safe [PDe-2]
- Recognises and describes strategies people can use to feel comfortable, resilient, and safe in situations [PD1-2]

Geography

- Identifies places and develops an understanding of the importance of places to people [GEe-1]
- Identifies ways in which people interact with and care for places [GE1-2]

History

- Demonstrates developing skills of historical inquiry and communication [HTe-2]
- Describe the effects of changing technology on people's lives overtime [HT1-3]



Identifying Hazards



Audience:
Primary School
Stage 2



Learning Areas:
PDHPE
Science
History



Type:
Museum Educator-led



Duration:
3.5 to 4 Hours*

Description of Program:

This program engages students in learning about fire safety through the lens of personal safety, safety in the home and safety when at school. Students are led in discussion of concepts such as what is an emergency and what are fire hazards? Students are then asked how firefighters manage fire hazards and discuss the equipment used by firefighters before commencing a role play exercise on fire safety in the home. This tests students on their ability to recall what they have learnt about personal safety and fire safety in the home.

Students are invited to explore the Museum of Fire and its exhibitions which show the historical development of firefighting across time and how firefighters as we know them have changed. This portion is a self-guided experience where teachers are provided with a walking trail guide to pose questions to the students and provide extra information on the displays.

An optional activity is a fire engine ride in a vintage fire engine, providing the experience to the students as to what it was like for firefighters to respond under lights and sirens back in 1969.

Cost:

\$12.50 per student and teachers free of charge (per a 1:10 staffing ratio, additional adults cost \$9.50).

Deposit:

A non-refundable deposit of \$187.50 (15 students) must be paid in total 2 weeks prior to visit.

*Duration of program is dependent on size of the group and needs of the group, the Museum can tailor its programs to be shorter or longer where required.

Curriculum Links (NSW Syllabus for Australian Curriculum):

PDHPE

- Describes how contextual factors are interrelated and how they influence health, safety, wellbeing, and participation in physical activity [PD2-6]
- Describes strategies to make home and school healthy, safe, and physically active spaces [PD2-7]
- Demonstrates self-management skills to respond to their own and others' actions [PD2-9]

Science

- Describes the characteristics and effects of common forms of energy, such as light and heat [ST2-2DP-T]

History

- Describes and explains how significant individuals, groups and events contributed to changes in the local community over time [HT2-2]



Bushfires



Audience:
Primary School
Stage 3



Learning Areas:
Geography
History



Type:
Museum Educator-led



Duration:
3.5 to 4 Hours*

Description of Program:

This program, conducted by one of our Museum Educators, discusses the impact of bushfires on people, places, and environments. Students are asked how we can prevent bushfires and learn about how fire can be beneficial to the environment. Students will consider how First Nations people have used bushfires for the management of places and environments before colonial settlement. Students are then encouraged to participate in a role play exercise on home fire safety which demonstrates the roles of all emergency services at an emergency.

Students are invited to explore the Museum of Fire and its exhibitions which show the historical development of firefighting across time and how firefighters as we know them have changed. This portion is a self-guided experience where teachers are provided with a walking trail guide to pose questions to the students and provide extra information on the displays.

An optional activity is a fire engine ride in a vintage fire engine, providing the experience to the students as to what it was like for firefighters to respond under lights and sirens back in 1969.

Cost:

\$12.50 per student and teachers free of charge (per a 1:10 staffing ratio, additional adults cost \$9.50).

Deposit:

A non-refundable deposit of \$187.50 (15 students) must be paid in total 2 weeks prior to visit.

*Duration of program is dependent on size of the group and needs of the group, the Museum can tailor its programs to be shorter or longer where required.

Curriculum Links (NSW Syllabus for Australian Curriculum):

Geography (ties into the factors that shape places unit)

- Describe the diverse features and characteristics of places, and environments GE3-1
- Explains interactions and connections between people, places, and environments GE3-2
- Compares and contrasts influences on the management of places and environments GE3-3
- Acquires, processes, and communicates geographical information using geographical tools for inquiry GE3-4

History

- Describes and explains the significance of people, groups, places, and events to the development of Australia HT3-1



Any further questions?

If you have any other questions you are welcome to contact us:

T: (02) 4731 3000

E: ea@museumoffire.com.au

For more information about planning your visit, accessibility, and about the Museum visit our website www.museumoffire.net

We are always happy to hear about your experience at the Museum, so if you have any comments or queries, please let us know.

